

MODERN APARTMENT IN PANTHEA - 2 BEDROOM

#2078

€420,000 + НДС

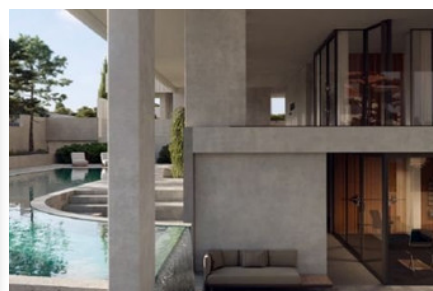
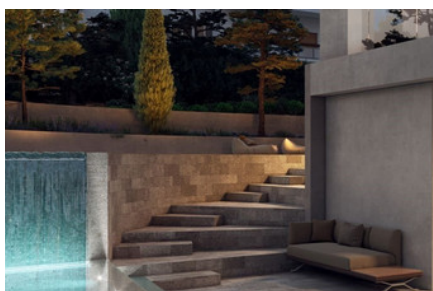
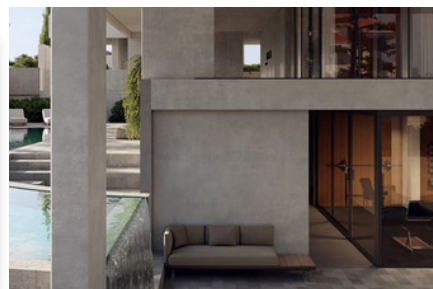

 Спальни: 2

 Ванные комнаты: 2

 Общая площадь: 87m²

 Крытая веранда: 25m²

 Статус: Under construction



Grigori Afxentiou 8A,
4005, Mesa Geitonia
Limassol

sales@quastilo.com
+357 95 727 000
quastilo.com



P R O P E R T Y F O R S A L E

MODERN APARTMENT IN PANTHEA - 2 BEDROOM

ОБЗОР

 Limassol, Panthea  Apartment  2078

ОПИСАНИЕ

A newly designed project, located in one of Limassol's prime locations, Panthea area. Contemporary design and elegant layout ideal for modern urban living. The building will accommodate luxurious 2- and 3-bedroom apartments with limitless natural light and unforgettable views of Limassol's coastline and city. A fully equipped gym and a communal swimming pool will add comfort and luxury to all residents. Don't miss this opportunity to own this amazing property, that can bring you, either an income with high rental returns or a permanent home.

УДОБСТВА

Aircondition, Provision

Heating, Provision

Parking, Covered

Pool, Communal

Elevator

Storage

Solar water heater

ХАРАКТЕРИСТИКИ

Thermal insulation

Fitted wardrobes

Pressurized water system

Double glazing

Guest WC

Veranda

Rental potential

Luxury specifications

Modern design

Near amenities



Grigori Afxentiou 8A,
4005, Mesa Geitonia
Limassol

sales@quastilo.com
+357 95 727 000
quastilo.com



P R O P E R T Y F O R S A L E