

BEAUTIFUL VILLA IN GERMASOGEIA - 3 BEDROOM

#1985

€880,000 + НДС

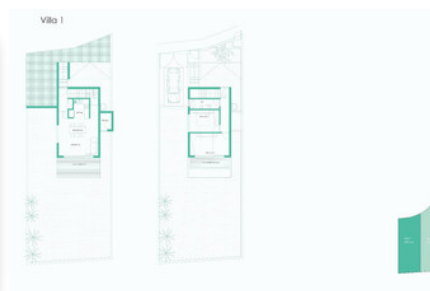

Спальни: 4



Ванные комнаты: 4



Общая площадь: 164m²



Участок: 410m²



Статус: Off plan



Бассейн: Private, Salt wa...



Grigori Afxentiou 8A,
4005, Mesa Geitonia
Limassol

sales@quastilo.com
+357 95 727 000
quastilo.com



P R O P E R T Y F O R S A L E

BEAUTIFUL VILLA IN GERMASOGEIA - 3 BEDROOM

ОБЗОР

 Limassol, Germasogeia  Villa  1985

ОПИСАНИЕ

This villa is a well-thought designed property located in Kefalokremmos, Germasogeia. A really unique location with brand-new homes, great infrastructure and tranquil surroundings just three minutes drive from the roundabout. Excellent area for families that are looking to live in a safe and clean environment that pleases the eye. Most probably the nicest area in Limassol for villa developments. The 40% density of the area assures that only private homes can be built. This villa has a total of three bedrooms, all of them being ensuite. There is an additional one ensuite studio on a separate housing unit which can be used for the as a guest bedroom, as an office or a gym. The villa enjoys high ceilings with top to floor thermo-isolated aluminum system windows, an open plan kitchen-living room area with a modern fireplace covering both areas, a large island bar and a dinning area. The swimming pool its dressed with turquoise tone-color tiles. The property has a south orientation and enjoys beautiful views to the sea towards the green valley of Germasogeia. Great to be used as a family residence.

УДОБСТВА

| | | |
|---------------------------|--------------------|--------------------------------------|
| Aircondition, Provision | Heating, Provision | Parking, Garage, double |
| Pool, Private, salt water | Storage | Landscaped garden |
| Maid's room | Outdoor shower | Solar photovoltaic panels, Provision |

ХАРАКТЕРИСТИКИ

| | | |
|--------------------------|-------------------------|----------------------------------|
| Bicycle parking | Easy access to highway | Combined kitchen and dining area |
| High ceilings | Fitted wardrobes | Guest cloakroom |
| Entrance gate, automated | Water softener | Garden |
| Pressurized water system | Investment opportunity | Bright |
| Open plan | Alarm system, Provision | Semi-solid parquet flooring |
| Double glazing | Veranda | Quiet area |
| Granite countertops | CCTV, Provision | En suite bathroom |
| En suite shower | Sea view | Indoor fireplace |



Grigori Afxentiou 8A,
4005, Mesa Geitonia
Limassol

sales@quastilo.com
+357 95 727 000
quastilo.com



P R O P E R T Y F O R S A L E