

2 CONSECUTIVE  
RESIDENTIAL PLOTS IN  
PANTHEA - 1110M<sup>2</sup>

#1720

€700,000 + НДС

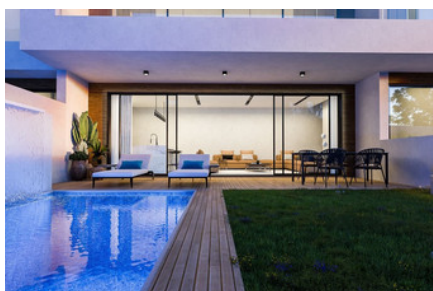

Подкатегория: Residential



Площадь: 1110m<sup>2</sup>



Зона: Ka7



Коэффициент застройки: 8



Коэффициент покрытия:



Макс высота: 13.5m



Grigori Afxentiou 8A,  
4005, Mesa Geitonia  
Limassol

sales@quastilo.com  
+357 95 727 000  
quastilo.com



P R O P E R T Y F O R S A L E

# 2 CONSECUTIVE RESIDENTIAL PLOTS IN PANTHEA - 1110M<sup>2</sup>

## ОБЗОР

 Limassol, Agia Fyla  Building Plot  1720

## ОПИСАНИЕ

Located in Panthea, one of the most sought-after areas of Limassol, with mountain views and sea views from the top. Two consecutive plots 526m<sup>2</sup> and 584m<sup>2</sup> and falls within the Residential Planning Zone Ka7 with 80% build factor and 45% cover factor. If you are looking for land development for apartments or houses this opportunity is ideal.

## ХАРАКТЕРИСТИКИ

Easy access to highway	City view	Mountain view
Sea view	Near amenities	

## РАССТОЯНИЯ

<b>Amenities:</b> 500 m	<b>Airport:</b> 60 km	<b>Sea:</b> 4 km
<b>Public transport:</b> 200 m	<b>Schools:</b> 500 m	<b>Resort:</b> 4 km



Grigori Afxentiou 8A,  
4005, Mesa Geitonia  
Limassol

sales@quastilo.com  
+357 95 727 000  
quastilo.com



P R O P E R T Y F O R S A L E