

MODERN PENTHOUSE APARTMENT IN PANTHEA - 2 BEDROOM

#2083

€465,000 + VAT

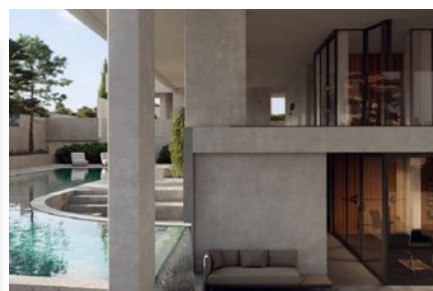
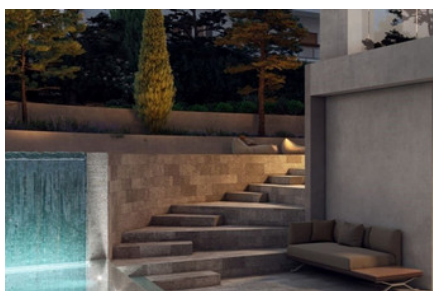
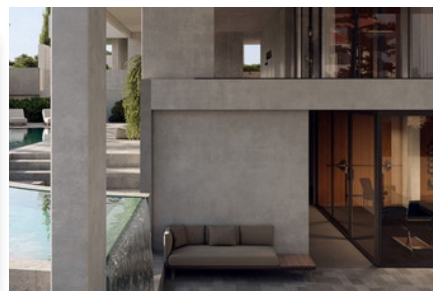

 Bedrooms: 2

 Bathrooms: 2

 Covered: 87m²

 Covered veranda: 25m²

 Roof garden: 43m²

 Floor: Penthouse



Grigori Afxentiou 8A,
4005, Mesa Geitonia
Limassol

sales@quastilo.com
+357 95 727 000
quastilo.com



P R O P E R T Y F O R S A L E

MODERN PENTHOUSE APARTMENT IN PANTHEA - 2 BEDROOM

OVERVIEW

 Limassol, Panthea  Apartment  2083

DESCRIPTION

A newly designed project, located in one of Limassol's prime locations, Panthea area. Contemporary design and elegant layout ideal for modern urban living. The building will accommodate luxurious 2- and 3-bedroom apartments with limitless natural light and unforgettable views of Limassol's coastline and city. A fully equipped gym and a communal swimming pool will add comfort and luxury to all residents. Don't miss this opportunity to own this amazing property, that can bring you, either an income with high rental returns or a permanent home.

FACILITIES

Aircondition, Provision	Heating, Provision	Parking, Covered
Pool, Communal	Elevator	Storage
Solar water heater		

FEATURES

Thermal insulation	Fitted wardrobes	Pressurized water system
Double glazing	Guest WC	Veranda
Rental potential	Luxury specifications	Modern design
Near amenities	Roof garden	



Grigori Afxentiou 8A,
4005, Mesa Geitonia
Limassol

sales@quastilo.com
+357 95 727 000
quastilo.com



P R O P E R T Y F O R S A L E